

\* "PATCHING EXISTING PAVEMENT" HAS BEEN INCLUDED AS A PAY ITEM ON MAPS. PATCHING MAY OR MAY NOT BE NEEDED DEPENDING ON CONDITION OF MAP SURFACE AT TIME THAT PAVING SEASON BEGINS. AREAS TO BE DELINIATED BY THE ENGINEER.

\* INCIDENTAL MILLING AT LOCATIONS AS DIRECTED BY THE ENGINEER

\*\*\* LEVELING AT LOCATIONS AS DIRECTED BY ENGINEER THE ENGINEER

PAVEMENT SCHEDULE	
C1	PROP. APPROX. 1¼" ASPHALT CONCRETE SURFACE COURSE, TYPE S9.5B, AN AVERAGE RATE OF 137.5 LBS. PER SQ. YD.
C2	PROP. APPROX. 1½" ASPHALT CONCRETE SURFACE COURSE, TYPE S9.5C, AN AVERAGE RATE OF 168 LBS. PER SQ. YD.
F1	ASPHALT SURFACE TREATMENT, MAT COAT WITH NO.78M STONE
T	SHOULDER RECONSTRUCTION
U	EXISTING PAVEMENT
V1	INCIDENTAL MILLING (See Tie in Detail)

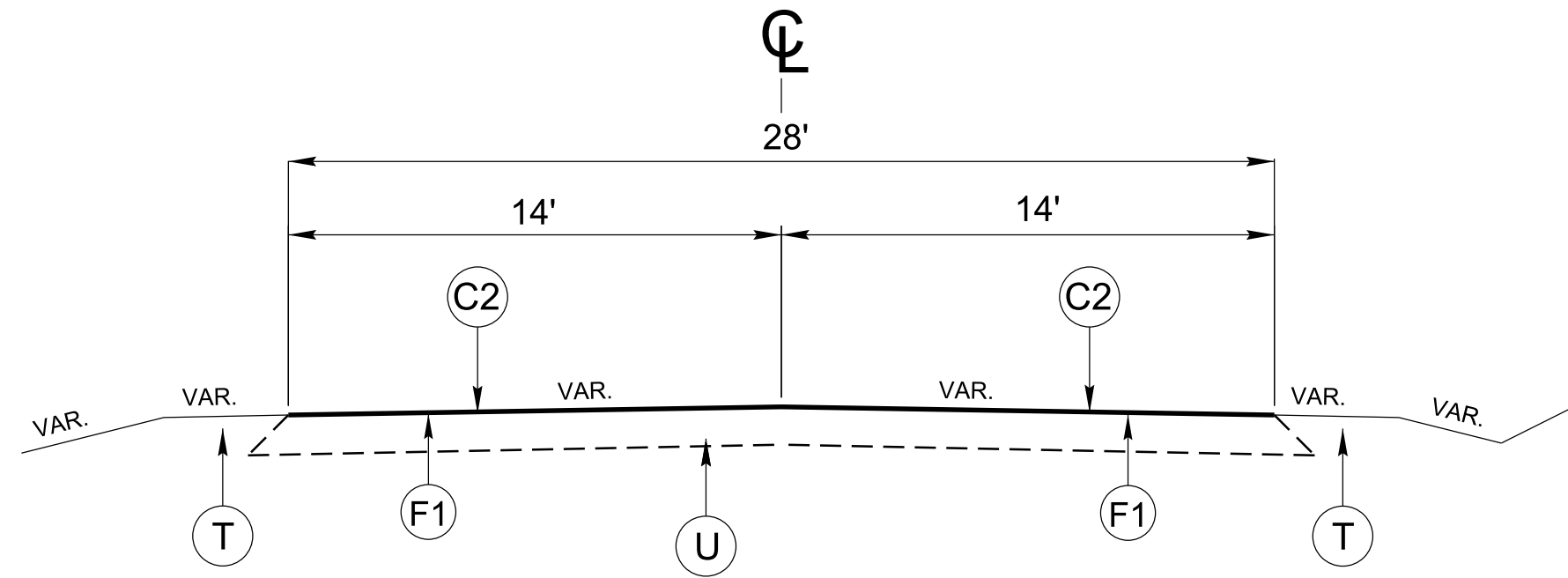

**TYPICAL SECTION NO. 1**  
 MAP 1 - NC 163 N FROM US 221 PROJECT LIMITS TO SR 1147

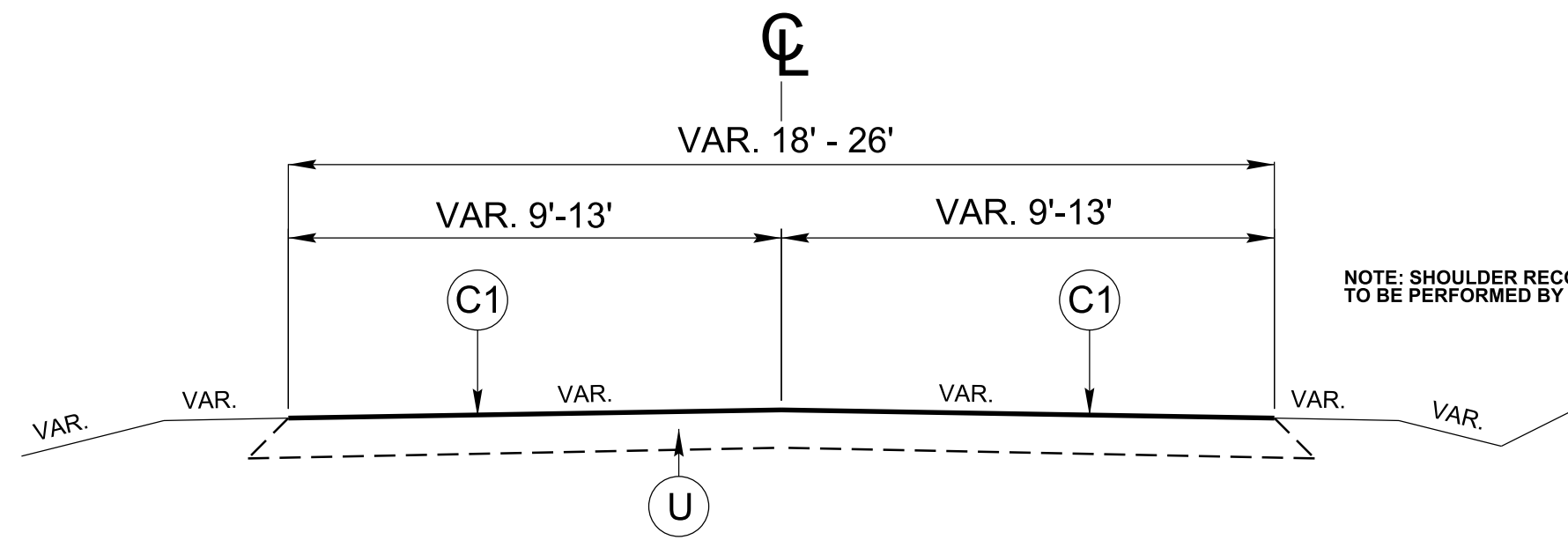
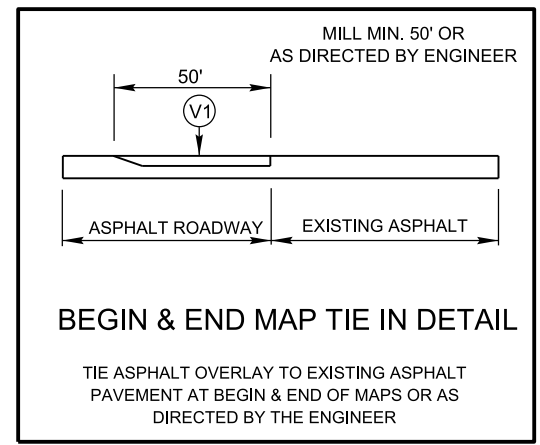

NOTE: SHOULDER RECONSTRUCTION ON MAPS #2-7 TO BE PERFORMED BY MAINTENANCE, AS NEEDED.

**TYPICAL SECTION NO. 2**  
 \*\*\* MAP 2 - SR 1126 FROM SR 1127 TO NC 88  
 \*\*\* MAP 3 - SR 1127 FROM NC 88 TO SR 1126  
 \*\*\* MAP 4 - SR 1127 FROM SR 1126 TO EOM  
 \*\*\* MAP 5 - SR 1228 FROM SR 1125 TO END PVMT  
 \*\*\* MAP 6 - SR 1229 FROM SR 1228 TO END MAINT  
 \*\*\* MAP 7 - SR 1271 FROM SR 1228 TO CUL-DE-SAC

NOTE: TYPICALS ARE NOT TO SCALE

<b>ASHE COUNTY          PRIMARY &amp; SECONDARY ROADS          2025 ASPHALT RESURFACING</b>													
<table border="1"> <thead> <tr> <th>REVISIONS</th> <th>INIT.</th> <th>DATE</th> </tr> </thead> <tbody> <tr> <td> </td> <td> </td> <td> </td> </tr> <tr> <td> </td> <td> </td> <td> </td> </tr> <tr> <td> </td> <td> </td> <td> </td> </tr> </tbody> </table>			REVISIONS	INIT.	DATE								
REVISIONS	INIT.	DATE											
N.C. DEPARTMENT of TRANSPORTATION DIVISION of HIGHWAYS DIVISION ELEVEN		SCALE: N/A    DATE: 1/28/2025 PREPARED BY: DLH REVIEWED BY:											

8/17/99  
 29-JAN-2025 10:06  
 C:\Users\pavement\OneDrive\Documents\Mapa\Ashe\MicroStation\DK004091\_resurfacing\_typicals.dgn

**Ashe County CR  
DK00409 - 2025  
Map #1**

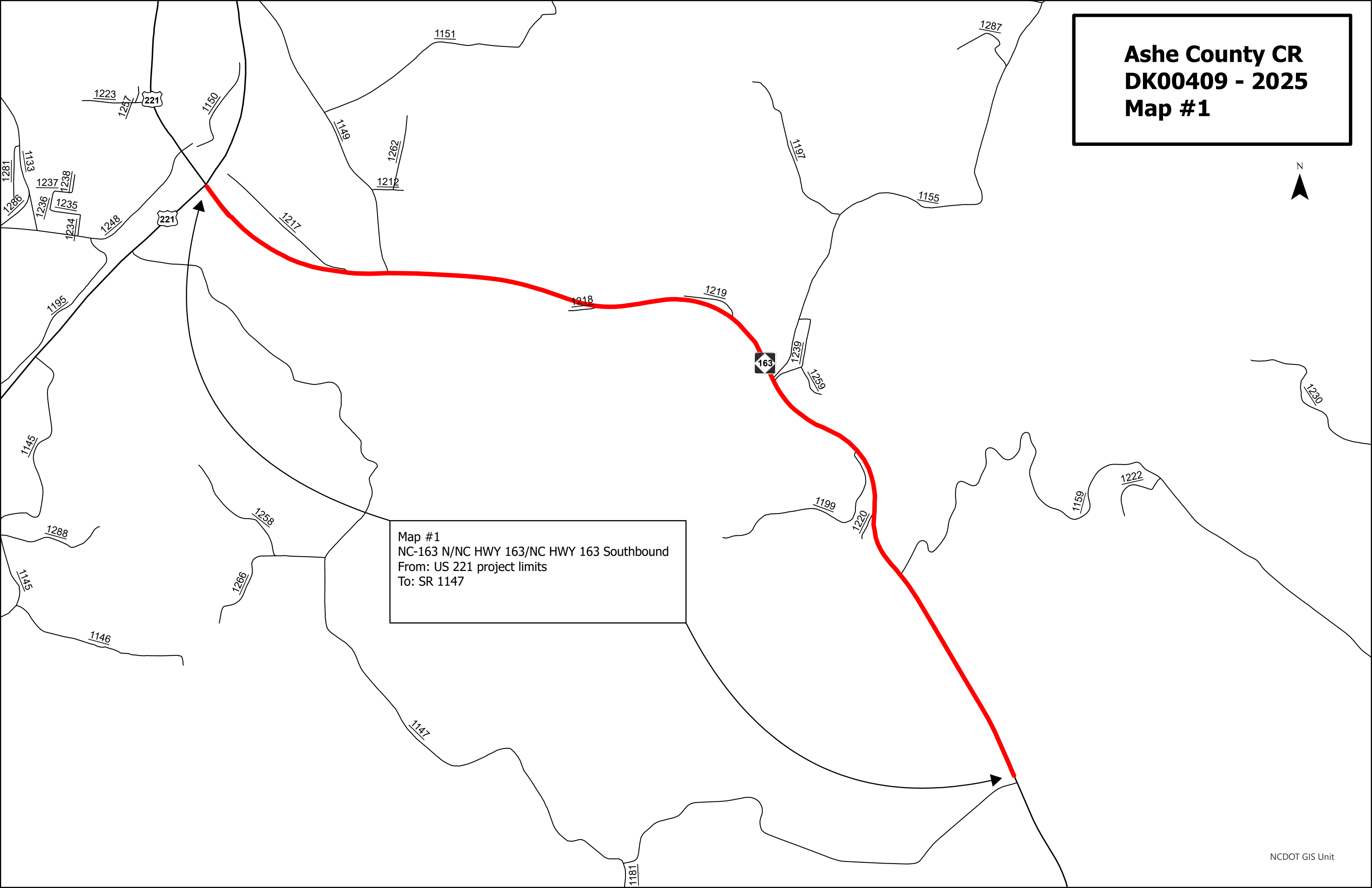

Map #1  
NC-163 N/NC HWY 163/NC HWY 163 Southbound  
From: US 221 project limits  
To: SR 1147

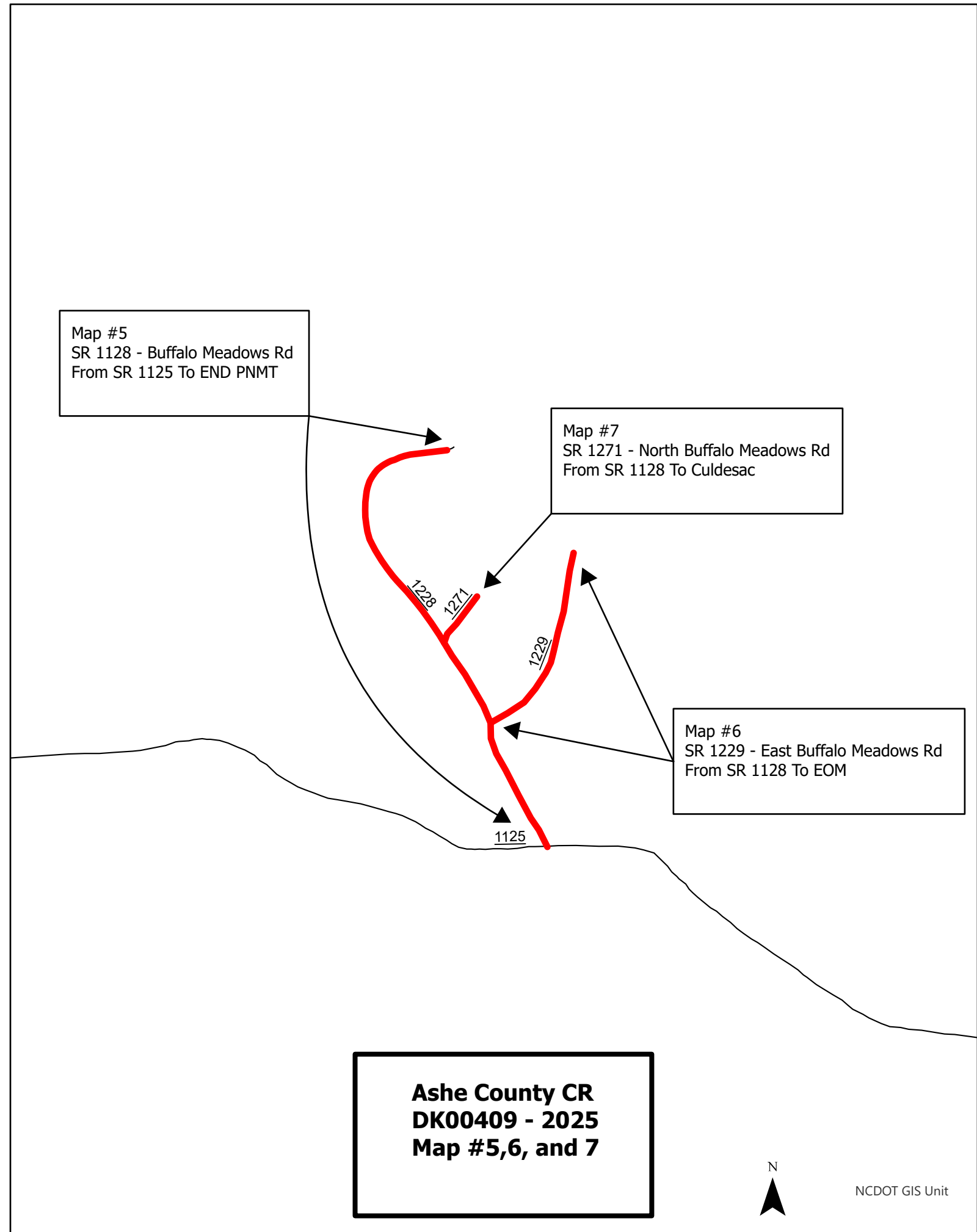
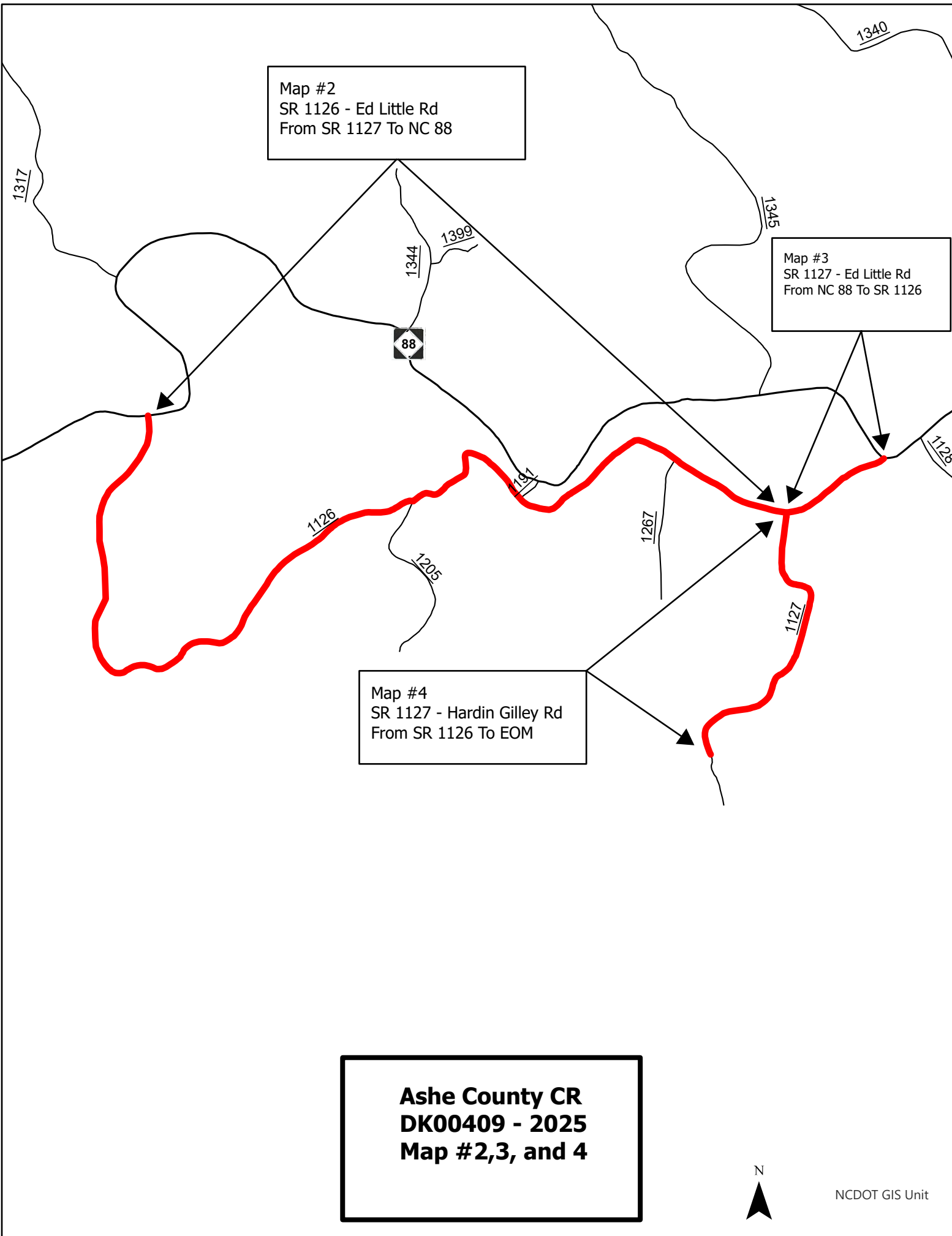

PROJECT NO.	SHEET NO.
DK00409	4

### SUMMARY OF QUANTITIES

PROJECT NO	COUNTY	MAP NO	ROUTE	DESCRIPTION	TYP NO	LANES	LANE TYPE	LENGTH		BEGIN MP	END MP	1220000000-E	1245000000-E	1260000000-E	1330000000-E	1519000000-E	1520000000-E	1523000000-E	1575000000-E	1704000000-E	1775500000-E	1838000000-E	2830000000-N	2845000000-N
								MI	FT			INCIDENTAL STONE BASE	SHOULDER RECONSTRUCTION	AGGREGATE SHOULDER BORROW	INCIDENTAL MILLING	SURFACE COURSE, S9.5B	LEVELING COURSE, TYPE S9.5B	SURFACE COURSE, S9.5C	ASPHALT BINDER FOR PLANT MIX	PATCHING EXISTING PAVEMENT	ASPHALT SURFACE TREATMENT, MAT COAT #78	EMULSION FOR ASPHALT SURFACE TREATMENT	ADJUST MANHOLES	ADJUST METER OR VALVE BOX
												TONS	SMI	TON	SY	TONS	TON	TONS	TONS	TONS	SY	GAL	EA	EA
2025CPT.11.06.10051	Ashe	1	NC-163 N / NC HWY 163/NC HWY 163 SOUTHBOUND	FROM US 221 PROJECT LIMITS TO SR 1147	1	2	2WU	3.38	28	0.15	3.53	68	6.8	930	500			5,387	369	1,063	63,850	19,155		
<b>TOTAL FOR PROJ NO. 2025CPT.11.06.10051</b>								<b>3.38</b>				<b>68</b>	<b>6.8</b>	<b>930</b>	<b>500</b>			<b>5,387</b>	<b>369</b>	<b>1,063</b>	<b>63,850</b>	<b>19,155</b>		
2025CPT.11.06.20051	Ashe	2	SR-1126 / ED LITTLE RD	FROM SR 1127 TO NC 88	2	2	2WU	2.69	18	0	2.69	54			20	2,259	1,176		223					
2025CPT.11.06.20051	Ashe	3	SR-1127 / ED LITTLE RD	FROM NC 88 TO SR 1126	2	2	2WU	0.28	20	0	0.28	6			22	261	136		26					
2025CPT.11.06.20051	Ashe	4	SR-1127 / HARDIN GILLEY RD	FROM SR 1126 TO EOM	2	2	2WU	0.74	20	0.28	1.02	15				600	359		62					
2025CPT.11.06.20051	Ashe	5	SR-1228 / BUFFALO MEADOWS RD	FROM SR 1125 TO END PNMT	2	2	2WU	0.37	23	0	0.37	7				397	207		39				2	
2025CPT.11.06.20051	Ashe	6	SR-1229 / EAST BUFFALO MEADOWS RD	FROM SR 1228 TO END MAINTENANCE	2	2	2WU	0.14	26	0	0.14	3				170	88		17				1	1
2025CPT.11.06.20051	Ashe	7	SR-1271 / N. BUFFALO MEADOWS RD	FROM SR 1228 TO CUL-DE-SAC	2	2	2WU	0.04	20	0	0.04	1				37	19		4					
<b>TOTAL FOR PROJ NO. 2025CPT.11.06.20051</b>								<b>4.26</b>				<b>86</b>			<b>42</b>	<b>3,724</b>	<b>1,985</b>		<b>371</b>				<b>3</b>	<b>1</b>
<b>GRAND TOTAL</b>								<b>7.64</b>				<b>154</b>	<b>6.8</b>	<b>930</b>	<b>542</b>	<b>3,724</b>	<b>1,985</b>	<b>5,387</b>	<b>740</b>	<b>1,063</b>	<b>63,850</b>	<b>19,155</b>	<b>3</b>	<b>1</b>

[Mile Posting Map](#)

PROJECT NO.	SHEET NO.
DK00409	5

## THERMOPLASTIC AND PAINT QUANTITIES

PROJECT NO	COUNTY	MAP NO	ROUTE	DESCRIPTION	TYP NO	LANES	LANE TYPE	LENGTH	WIDTH	BEGIN MP	END MP	4413000000-E	4725000000-E	4890000000-E		4892000000-N
												WORK ZONE	THERMOPLASTIC	HOT SPRAY THERMOPLASTIC	HOT SPRAY THERMOPLASTIC	POLYCARBONATE H-
												ADVANCE/GENERAL WARNING SIGNING	LEFT ARROW, 90 MIL	PAVEMENT MARKING LINES, 6", 65 MIL	PAVEMENT MARKING LINES, 4", 65 MIL	SHAPED MARKERS
												SF	EA	LF	LF	EA
2025CPT.11.06.10051	Ashe	1	NC-163 N / NC HWY 163/NC HWY 163 SOUTHBOUND	FROM US 221 PROJECT LIMITS TO SR 1147	1	2	2WU	3.38	28	0.15	3.53	250	8	72,738		200
<b>TOTAL FOR PROJ NO. 2025CPT.11.06.10051</b>								<b>3.38</b>				<b>250</b>	<b>8</b>	<b>72,738</b>		<b>200</b>
												<b>72,738</b>				
2025CPT.11.06.20051	Ashe	2	SR-1126 / ED LITTLE RD	FROM SR 1127 TO NC 88	2	2	2WU	2.69	18	0	2.69	200			57,889	
2025CPT.11.06.20051	Ashe	3	SR-1127 / ED LITTLE RD	FROM NC 88 TO SR 1126	2	2	2WU	0.28	20	0	0.28	52			6,026	
2025CPT.11.06.20051	Ashe	4	SR-1127 / HARDIN GILLEY RD	FROM SR 1126 TO EOM	2	2	2WU	0.74	20	0.28	1.02	112				
2025CPT.11.06.20051	Ashe	5	SR-1228 / BUFFALO MEADOWS RD	FROM SR 1125 TO END PNMT	2	2	2WU	0.37	23	0	0.37	52				
2025CPT.11.06.20051	Ashe	6	SR-1229 / EAST BUFFALO MEADOWS RD	FROM SR 1228 TO END MAINTENANCE	2	2	2WU	0.14	26	0	0.14	52				
2025CPT.11.06.20051	Ashe	7	SR-1271 / N. BUFFALO MEADOWS RD	FROM SR 1228 TO CUL-DE-SAC	2	2	2WU	0.04	20	0	0.04	52				
<b>TOTAL FOR PROJ NO. 2025CPT.11.06.20051</b>								<b>4.26</b>				<b>520</b>			<b>63,915</b>	
												<b>63,915</b>				
<b>GRAND TOTAL</b>								<b>7.64</b>				<b>770</b>	<b>8</b>	<b>72,738</b>	<b>63,915</b>	<b>200</b>
												<b>136,653</b>				

[Mile Posting Map](#)

- NOTES:  
 1) DETAIL DOES NOT APPLY TO OGAFD AND ULTRA-THIN BONDED WEARING COURSE.  
 2) BACKFILL SHOULDER WITH APPROVED MATERIAL.  
 3) THE SHOULDER WEDGE DEVICE MAY BE DISENGAGED AT PAVED DRIVEWAYS AND SIDE STREETS.

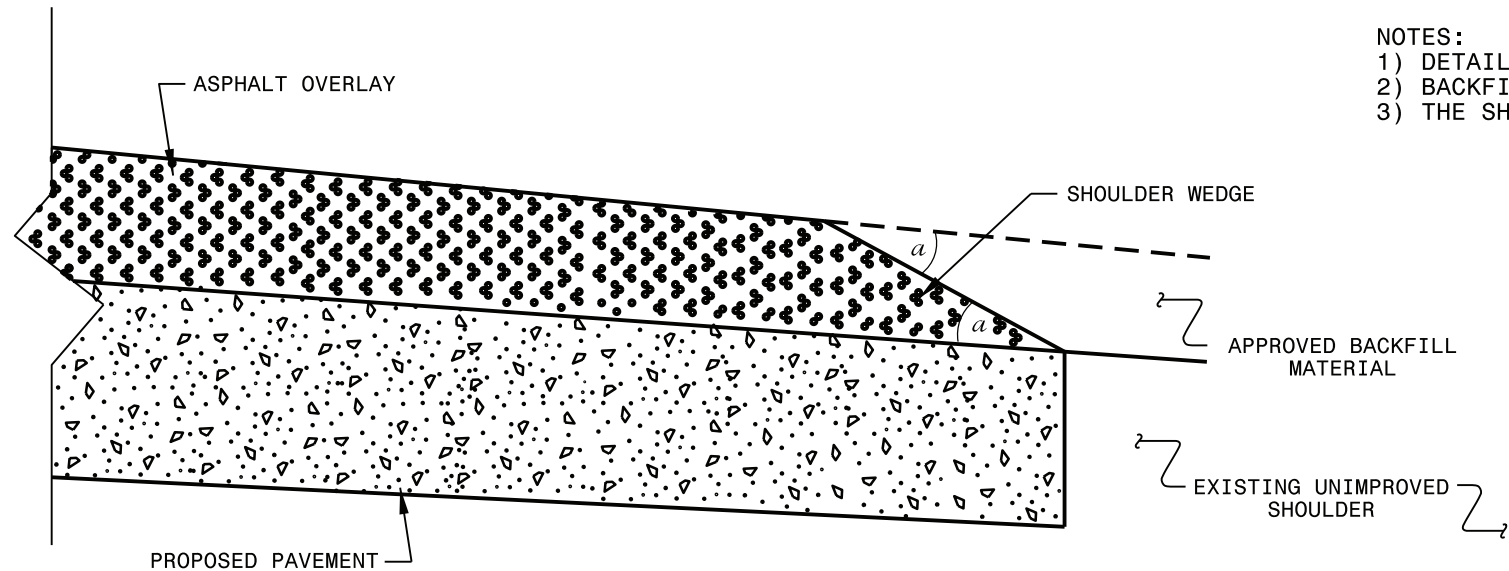

**SHOULDER WEDGE DETAIL**  
 (Resurfacing Projects w/ Widening or  
 with Existing Paved Shoulder having no dropoffs)

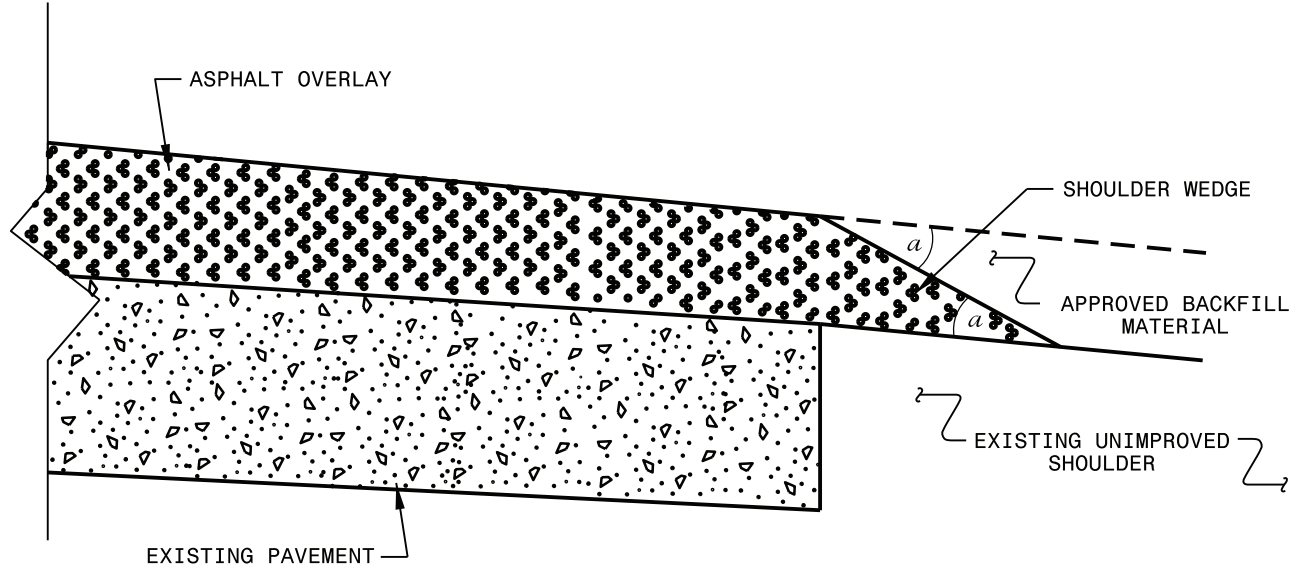

**SHOULDER WEDGE DETAIL**  
 (Resurfacing Projects w/ NO Widening)

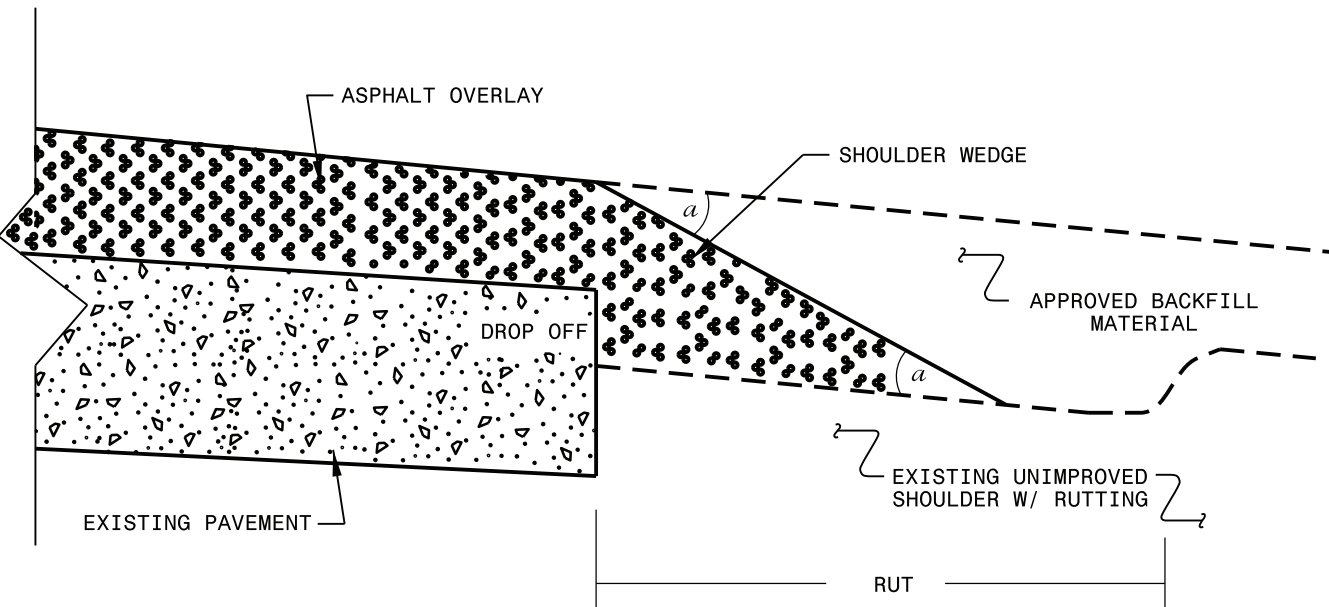

**SHOULDER WEDGE DETAIL**  
 (Resurfacing Adjacent to  
 Rutted Shoulder)

- SHOULDER WEDGE ANGLE = 30°

<b>CONTRACT STANDARDS AND DEVELOPMENT UNIT</b>	
Office 919-707-6950	FAX 919-250-4119
<b>SHOULDER WEDGE DETAILS</b>	
ORIGINAL BY: T.SPELL	DATE: 7-19-11
MODIFIED BY:	DATE: 10/16/12
CHECKED BY:	DATE:
FILE SPEC.: susr/details/stand/shoulderwedgedetail.dgn	

SYSTEMS DESIGN  
 USER NAME



# SIGNING FOR RESURFACING PROJECTS

**LEGEND**  
 ┆ STATIONARY SIGN  
 ← DIRECTION OF TRAFFIC FLOW

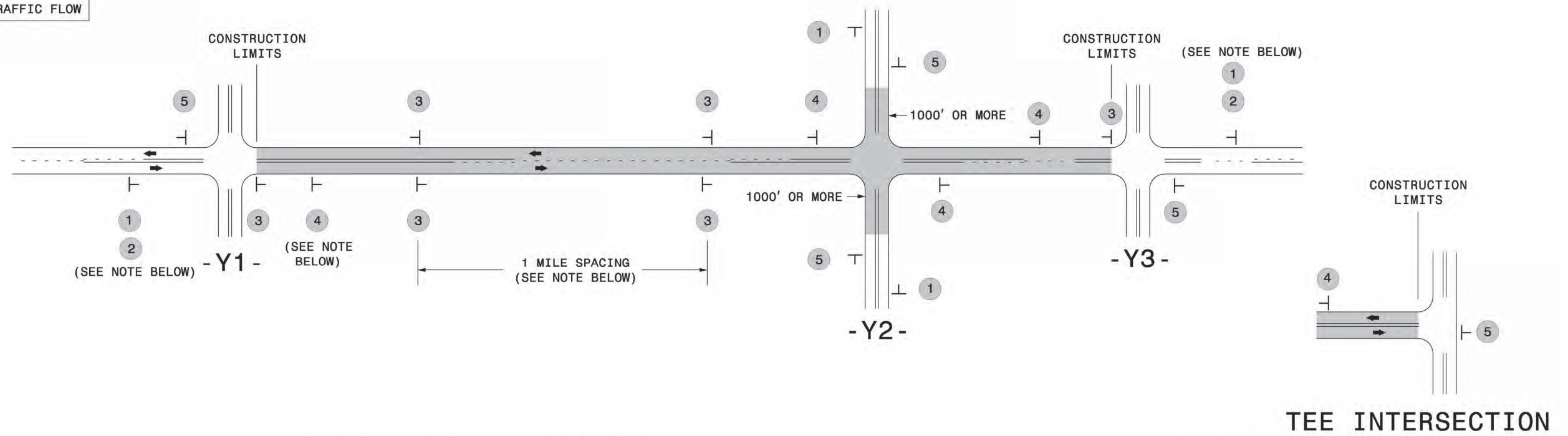

## MAINLINE (-L-) SIGNING

## -Y- LINE SIGNING

SIGNING NOTES AND PLACEMENT PER DIRECTION	1		PLACE 1000' PRIOR TO BEGINNING OF CONSTRUCTION LIMITS. ONLY USED ON -Y- LINES IF RESURFACING LIMITS EXTEND 1000' ALONG -Y- LINE.	<p>NO REQUIRED STATIONARY SIGNING FOR THE FOLLOWING -Y- LINE CONDITIONS:</p> <ol style="list-style-type: none"> <li>LESS THAN 1000' OF RESURFACING ALONG -Y- LINE</li> <li>SUBDIVISION ROADS</li> <li>DEAD END ROADS</li> </ol> <p>WHEN PAVING/CONSTRUCTION ACTIVITIES PROCEED ACROSS AN UNSIGNED -Y- LINE, PORTABLE ADVANCE WARNING SIGNS SHALL BE USED ALONG THE -Y- LINE AS SHOWN BELOW. REMOVE UPON COMPLETION OF WORK.</p> <div style="display: flex; justify-content: space-around;"> <div style="text-align: center;">             PLACED 500' IN ADVANCE OF FLAGGER.         </div> <div style="text-align: center;">             PLACED 250' IN ADVANCE OF FLAGGER.         </div> </div>
	2		#2 SIGN ONLY USED WHEN CONSTRUCTION LIMITS ARE 2 OR MORE MILES IN LENGTH. ROUND UP TO NEXT WHOLE NUMBER. (NO FRACTIONAL OR DECIMAL NUMBERS)	
	3		- PLACE INITIALLY AT THE CONSTRUCTION LIMITS AND SPACE 1 MILE APART THEREAFTER. - AT TEE INTERSECTIONS INSTALL INITIALLY 1/2 MILE FROM INTERSECTION AND SPACE 1 MILE APART THEREAFTER.	
	4		- THESE ARE FOR -Y- LINES THAT ARE "THROUGH" ROADWAYS. - DEAD END AND SUBDIVISION ROADS ARE NOT "THROUGH" ROADWAYS. - INSTALL 500' +/- FROM EACH -Y- LINE APPROACH AS SHOWN ABOVE. - FOR MULTIPLE -Y- LINES THAT ARE SEPARATED BY 0.25 MILES OR LESS, TREAT AS A SINGLE UNIT AND INSTALL WITHIN 500' OF EACH APPROACH. - A MAXIMUM OF 2 SIGN SETS PER MILE. DO NOT INSTALL WHEN -Y- LINES ARE WITHIN 0.5 MILES FROM "END ROAD WORK" SIGN. - FOR TEE INTERSECTIONS, INSTALL WITHIN 500' +/- OF THE INTERSECTION ALONG -L- LINE.	
	5		PLACE 500' FOLLOWING THE END OF CONSTRUCTION LIMITS OR AS SHOWN WHEN WORK ENDS AT A 3-WAY TEE INTERSECTION.	

THE ABOVE SIGNS ARE ALL THAT ARE REQUIRED FOR A CONTRACTOR TO BEGIN A RESURFACING CONTRACT. ANY ADDITIONAL SIGNS REQUESTED BY NCDOT DIVISIONS SHALL BE INSTALLED WITHIN 7 BUSINESS DAYS OF THE START OF CONTRACT WORK.

**MAPS LESS THAN 2 MILES**

FOR RESURFACING MAPS WITH CONSTRUCTION LIMITS LESS THAN 2 MILES IN LENGTH, NO STATIONARY SIGNS ARE REQUIRED. USE PORTABLE "ROAD UNDER CONSTRUCTION" OR "ROAD WORK AHEAD" SIGNS IN LIEU OF STATIONARY ADVANCE WARNINGS SIGNS.

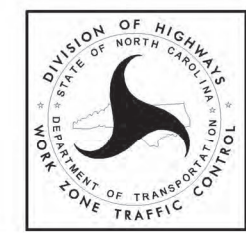

**ADVANCE WARNING SIGNS FOR RURAL AND SUBURBAN 2-LANE ROADWAY RESURFACING**

5/15/2017 5:11:00 PM WZTC\Resurfacing\2L2W & AST Resurfacing Details\Resurfacing\_AdvWarn\_2Ln.dgn User:keads





8/17/99

REVISIONS

**GENERAL NOTES:**

1. USE RAPID SET DYED CONCRETE WITH A MINIMUM COMPRESSIVE STRENGTH OF 4000 PSI.
2. REMOVE ALL FAULTY EXISTING BRICKWORK AND REPLACE WITH NEW BRICK MASONRY.
3. SHEER CUT RECTANGULAR EXCAVATION FOR THE ADJUSTMENT ON ALL SIDES. NO OVERSAW CUTS ALLOWED IN CORNERS.
4. FILL AREA BELOW 8" DEPTH WITH 78M OR NO. 57 CLEAN STONE.
5. MIX MORTAR TO NCDOT SPECIFICATIONS.
6. MORTAR JOINTS 1/2" +/- 1/8"

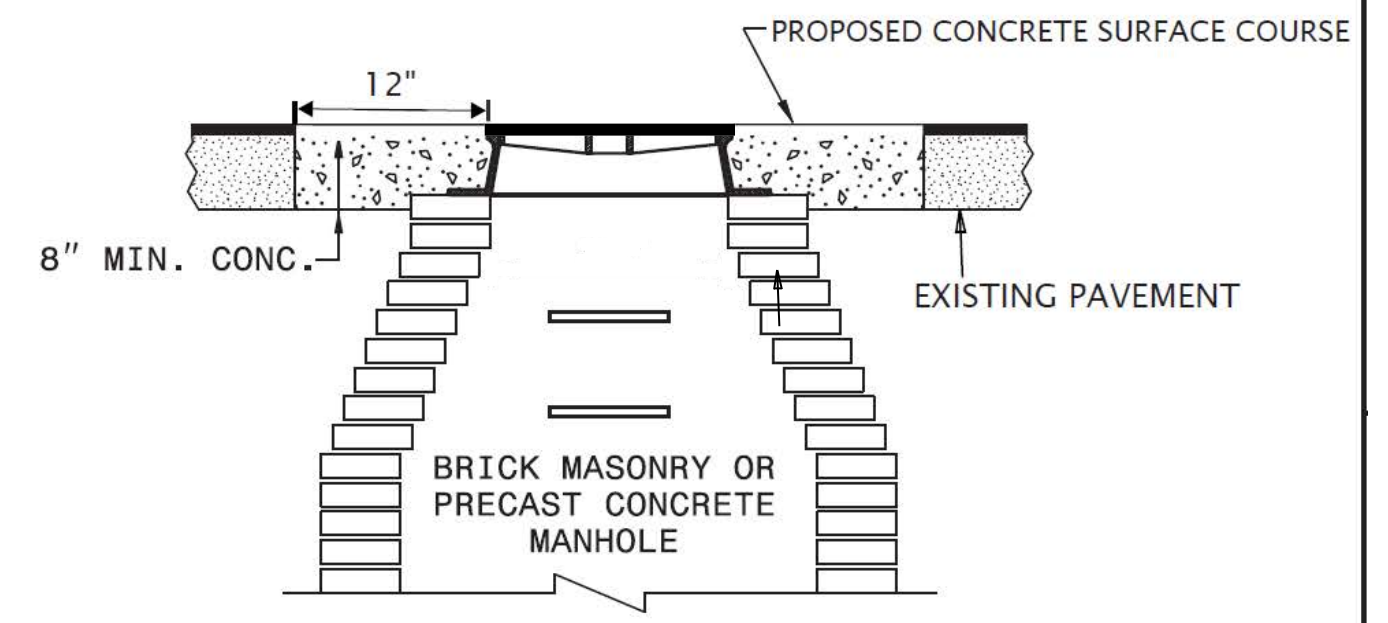

**MANHOLE CONCRETE ENCASEMENT**

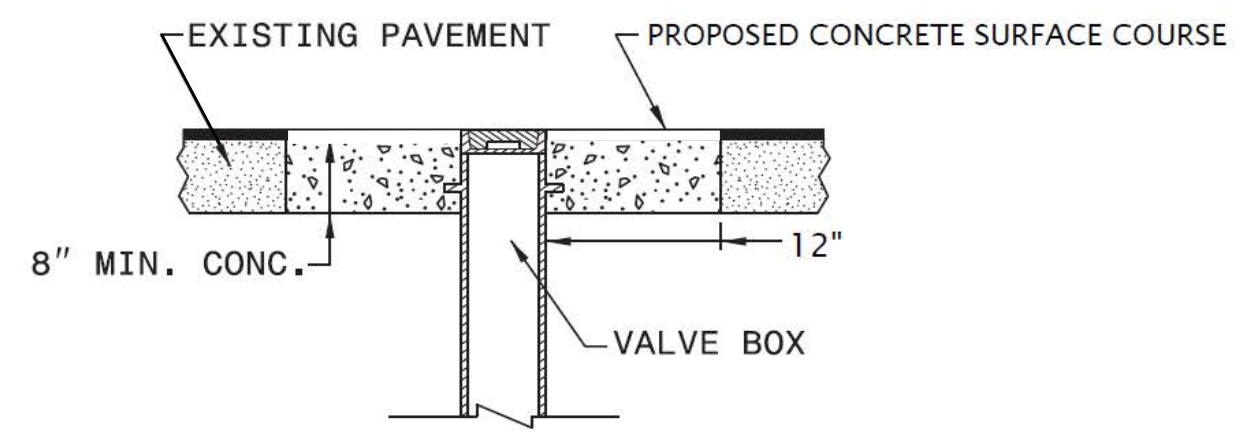

**VALVE BOX CONCRETE ENCASEMENT**

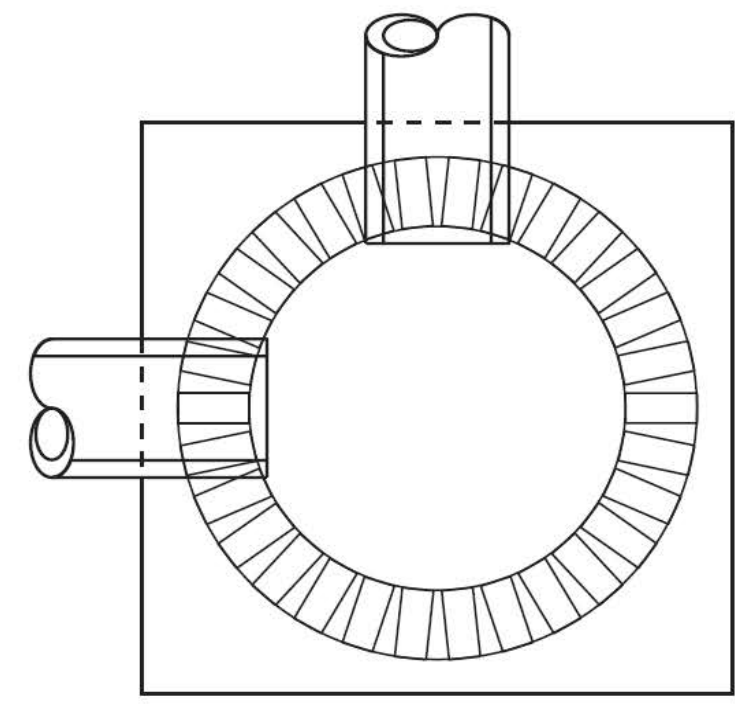

**ELEVATION VIEW**

PLACE BRICK ACCORDING TO ELEVATION VIEW

24-JAN-2016 13:31  
C:\Users\yokjmm1\Desktop\DETAIL\_PSHS\Microstation\_Files\MH\_Valve\_Adjust\_2015.dgn  
\$\$\$\$\$USERNAME\$\$\$\$\$